



SAT Amorphous

File No.

IP010

Version

A/0

Page

1

Model

C Core Specification

Effective date

2019.1.29

Amorphous C Core specification

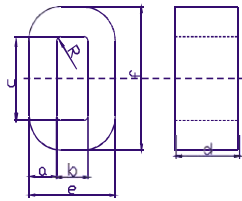

A-Core Build, B-window width, C-Window length, D-Core height; E-Core width
F-core length, Ae- core effective area , Lm-Magnetic length

Core No.	A (mm)	B (mm)	C (mm)	D (mm)		E (mm)		F (mm)		Lm (cm)	Ae (cm ²)	Wa (cm ²)	Ap (cm ⁴)	Mass (g)	Price (\$)
SATCC-4	9	±0.5	10	32.8	15	±0.5	28.0	±1.5	50.8	±1.25	11.2	1.20	3.3	3.606	97
SATCC-4B	9	±0.5	11	33	15	±0.5	29.0	±1.5	51	±1.25	11.5	1.20	3.6	3.991	99
SATCC-6.3	10	±0.5	11	33	20	±0.5	31.0	±1	53	±2	11.8	1.78	3.6	5.912	150
SATCC-8	11	±0.8	13	30	20	±0.5	35.0	±1	52	±2	11.9	1.96	3.9	6.987	167
SATCC-10	11	±0.8	13	40	20	±0.5	35.0	±1	62	±2	13.7	1.96	5.2	9.316	193
SATCC-16A	11	±0.8	13	40	25	±0.5	35.0	±1	62	±2	13.7	2.45	5.2	11.645	241
SATCC-16B	11	±0.8	13	50	25	±0.5	35.0	±1	72	±2	15.7	2.45	6.5	14.557	276
SATCC-20	11	±0.8	13	50	30	±0.5	35.0	±1	72	±2	15.7	2.94	6.5	17.468	331
SATCC-21	10	±0.8	17	32	40	±0.5	37.0	±1	52	±2	13.6	3.56	5.4	17.720	348
SATCC-25	13	±0.8	15	56	25	±0.5	41.0	±1	82	±2	17.9	2.89	8.4	22.232	373
SATCC-26	16	±1	40	45	20	±0.5	72.0	±1	77	±2	21.7	2.85	18.0	46.907	443
SATCC-26B	16	±1	20	50	20	±0.5	52.0	±1	82	±2	18.7	2.85	10.0	26.059	382
SATCC-32	13	±0.5	15	56	30	±0.5	41.0	±1	82	±2	17.9	3.47	8.4	26.678	447
SATCC-32+	13	±0.5	16	58	30	±0.5	42.0	±1	84	±2	18.8	3.47	6.5		450
SATCC-33	10	±0.8	20	58	40	±0.5	40.0	±1	78	±2	18.4	3.56	11.6	37.786	470
SATCC-34	15	±0.8	30	60	25	±0.5	60.0	±1	90	±2	22.4	3.34	18.0	54.969	536
SATCC-40	13	±0.8	15	56	35	±0.5	41.0	±1	82	±2	17.9	4.05	8.4	31.124	522
SATCC-50	16	±1	20	70	25	±0.5	52.0	±1	102	±2	22.7	3.56	14.0	45.604	580
SATCC-63	16	±1	20	70	30	±0.5	52.0	±1	102	±3	22.7	4.27	14.0	54.724	696
SATCC-64	16	±1	20	43	45	±0.5	52.0	±1	75	±2	17.3	6.41	8.6	50.425	795
SATCC-65	16	±1	20	58	45	±0.5	52.0	±1	90	±2	20.3	6.41	11.6	68.015	933
SATCC-70	20	±1	40	60	30	±0.5	80.0	±1	100	±2	25.9	5.34	24.0	117.266	994
SATCC-80	16	±1	20	70	40	±1	52.0	±1	102	±3	22.7	5.70	14.0	72.966	928
SATCC-84	12	±1	30	60	20	±1	54.0	±1	84	±3	21.4	2.14	18.0	35.180	329
SATCC-100	16	±1	20	70	45	±1	52.0	±1	102	±3	22.7	6.41	14.0	82.086	1043
SATCC-117	20	±1	35	77	20	±1	75.0	±1	117	±3	28.3	3.56	27.0	87.787	724



SAT Amorphous

File No.

IP010

Version

A/0

Page

2

Model

C Core Specification

Effective date

2019.1.29

Amorphous C Core specification

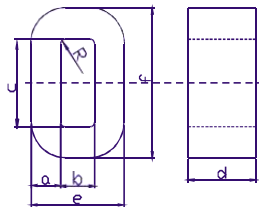

A-Core Build, B-window width, C-Window length, D-Core height; E-Core width
F-core length, Ae- core effective area, Lm-Magnetic length

Core No.	A (mm)		B (mm)	C (mm)	D (mm)		E (mm)		F (mm)		Lm (cm)	Ae (cm ²)	Wa (cm ²)	Ap (cm ⁴)	Mass (g)	Price (\$)
SATCC-128	22	±1	35	84	25	±1	79.0	±1	128	±4	30.4	4.90	29.4	131.680	1067	
SATCC-140	26	±1	45	88	30	±1	97.0	±1	140	±4	34.4	6.94	39.6	251.536	1716	
SATCC-140A	26	±1	45	88	40	±1	97.0	±1	140	±4	34.4	9.26	39.6	335.382	2287	
SATCC-168S	20.4	±0.5	30	154.2	20	±1	70.8	±1	195	±4	43.2	3.63	46.3	153.701	1127	
SATCC-125	19	±1	25	83	35	±1	63.0	±1	121	±3	27.2	5.92	20.8	112.370	1157	
SATCC-160	19	±1	25	83	40	±1	63.0	±1	121	±3	27.2	6.76	20.8	128.423	1322	
SATCC-180	25	±1	35	65	30	±1	85.0	±1	115	±3	27.9	6.68	22.8	138.948	1335	
SATCC-193	40	±1	50	113	40	±1	130.0	±1	193	±4	44.6	14.24	56.5	736.172	4565	
SATCC-200B	14	±0.5	35	93	68.3	±0.5	63.0	±1	121	±3	29.6	8.50	32.6	277.000	1771	
SATCC-200	19	±1	25	83	50	±1	63.0	±1	121	±3	27.2	8.46	20.8	160.529	1653	
SATCC-210	40	±1	50	130	50	±1	130.0	±1	210	±4	48.0	17.80	65.0	1058.655	6140	
SATCC-367s	25.8	±1	67	97.8	25	±0.5	118.6	±1	149.4	±4	40.5	5.74	65.5	344.179	1671	
SATCC-250	19	±1	25	90	60	±1	63.0	±1	128	±3	28.6	10.15	22.5	208.881	2085	
SATCC-260	23.7	±1	25	78	40	±1	72.4	±1	125.4	±3	28.0	8.44	19.5	150.541	1699	
SATCC-270	20	±1	30	70	60	±1	70.0	±1	110	±3	26.3	10.68	21.0	205.216	2015	
SATCC-275	25	±1	35	78	50	±1	85	±1	128	±3	30.106	11.125	27.3	277.897	2404.792	
SATCC-310	25	±1	82	90	25	±0.5	132.0	±2	140	±4	42.3	5.56	73.8	375.619	1687	
SATCC-320	22	±1	35	85	50	±1	79.0	±1	129	±4	30.6	9.79	29.8	266.496	2148	
SATCC-330	25		90	94	25	±1	140.0	±2	144	±4	45.0	5.56	84.6	430.588	1796	
SATCC-340	26	±1	80	104	30	±0.5	132.0	±1	156	±4	45.0	6.94	83.2	528.481	2241	
SATCC-380	30	±1	86	95	30	±0.5	146.0	±2	155	±4	45.6	8.01	81.7	598.792	2624	
SATCC-400	22	±1	35	85	65	±1	79.0	±1	129	±4	30.4	12.73	29.8	346.445	2777	
SATCC-410	32	±1	50	113	40	±1	114.0	±1	177	±4	42.6	11.39	56.5	588.938	3488	
SATCC-415	22	±1	46	72	80	±1	90.0	±1	116	±3	29.3	15.66	33.1	474.694	3296	
SATCC-500	25	±1	40	85	55	±1	90.0	±1	135	±4	32.3	12.24	34.0	380.709	2841	
SATCC-630	25	±1	40	85	70	±1	90.0	±1	135	±4	32.3	15.58	34.0	484.538	3616	



SAT Amorphous

File No.

IP010

Version

A/0

Page

3

Model

C Core Specification

Effective date

2019.1.29

Amorphous C Core specification

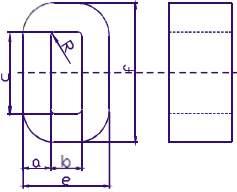

A-Core Build, B-window width, C-Window length, D-Core height; E-Core width
F-core length, Ae- core effective area , Lm-Magnetic length

Core No.	A (mm)		B (mm)	C (mm)	D (mm)		E (mm)		F (mm)		Lm (cm)	Ae (cm ²)	Wa (cm ²)	Ap (cm ⁴)	Mass (g)	Price (\$)
SATCC-650	40	±1	40	115	40	±1	120.0	±1	195	±5	43.6	14.24	46.0	599.362	4454	
SATCC-800A	25	±1	40	85	85	±1.5	90.0	±1	135	±4	32.3	18.91	34.0	588.368	4391	
SATCC-800B	30	±1	40	95	85	±1.5	100.0	±1	155	±4	35.9	22.70	38.0	789.105	5851	
SATCC-1000	33	±1	40	105	85	±1.5	106.0	±1	171	±5	38.8	24.96	42.0	959.386	6963	
SATCC-1050	40	±1	50	100	70	±1.5	130.0	±1	180	±5	42.6	24.92	50.0	1140.090	7615	
SATCC-1500	40	±1	64	160	80	±1.5	144.0	±1	240	±5	57.4	28.48	102.4	2668.462	11729	
SATCC-L1	8	±0.5	14	31	40	±1	30.0	±1	47	±1.5	11.2	2.85	4.3	11.310	215	
SATCC-L2	8	±0.5	20	54	40	+0.5	36.0	±1	70	+2	17.0	2.85	10.8	28.144	330	

Above price for reference